

**NOTES:**

- CHANDELIER HEIGHT IS TYPICAL FOR ALL CHANDELIER. ALL OTHER DIMENSIONS AS NOTED.
- REFERS TO VENUE FOR LOAD RATING OF RIGGING POINTS.
- TRUSS TO BE TRIMMED TO BOTTOM EDGE OF TRUSS.
- ALL TRUSS TO BE 1"X1" BOX TRUSS. REFER TO OTHERS FOR ANY RIGGING INFORMATION.

**LEGEND**

ROGUE R1 WASH

ELATION PICASSO

VIDEO WALL

TRIM / CEILING HEIGHT

ARCH. LIGHTING FIXTURE

RIGGING POINT

**DRAWING SCHEDULE**

VER.	DATE	DESCRIPTION
1	10/03/22	DRAFT A - DO NOT BID
2	10/04/22	FOR VENUE REVIEW
3	10/12/22	VERSION B
4	10/16/22	VERSION C - SEATING UPDATE

**UNIQUE STAGING SOLUTIONS**

THIS DRAWING REPRESENTS VISUAL CONCEPTS AND CONSTRUCTION SUGGESTIONS ONLY.

IT DOES NOT REPLACE THE KNOWLEDGE AND ADVICE OF A LICENSED ENGINEER, ELECTRICIAN, OR RIGGING. THE DESIGNER IS UNQUALIFIED TO DETERMINE THE STRUCTURAL OR ELECTRICAL APPROPRIATENESS OF THIS DESIGN, AND WILL NOT ASSUME RESPONSIBILITY FOR INSTALLATION, CONSTRUCTION, HANDLING, OR USE OF EQUIPMENT.

ALL MATERIALS AND CONSTRUCTION MUST COMPLY WITH THE MOST STRINGENT APPLICABLE FEDERAL AND LOCAL FIRE, SAFETY, ENERGY, AND ENVIRONMENTAL CODES.

**OMNI LOUISVILLE HOTEL**

LOUISVILLE, KY

**BALLROOM**

SCALE: 3/16"=1'-0" EXCEPT WHERE NOTED

DATE: 10/24/22

DRAWN: CF

**1**  
of 2



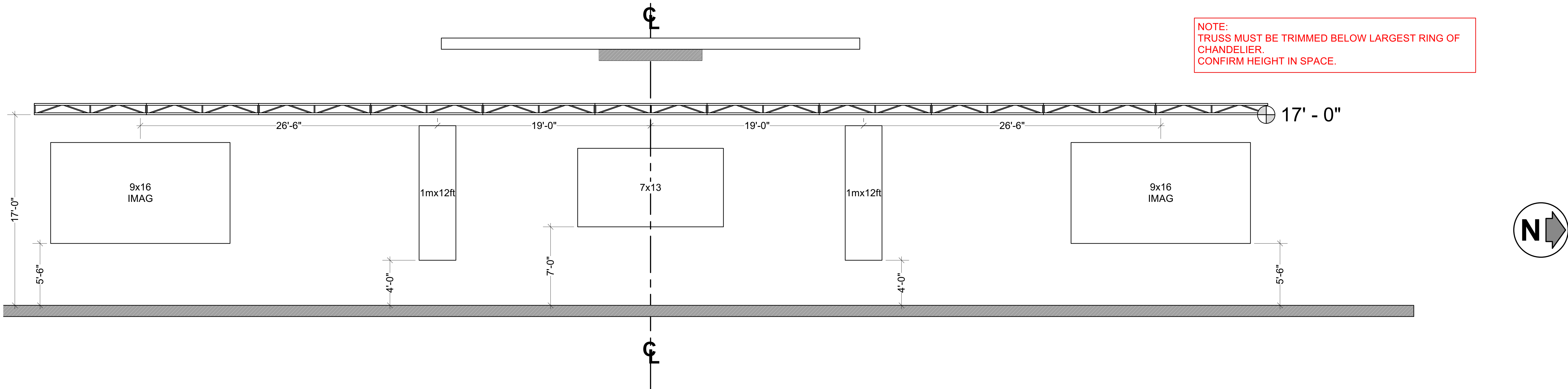

**NOTES:**

- CHANDELIER HEIGHT IS TYPICAL FOR ALL CHANDELIER. ALL OTHER DIMENSIONS AS NOTED.
- REFERS TO VENUE FOR LOAD RATING OF RIGGING POINTS.
- TRUSS TO BE TRIMMED TO BOTTOM EDGE OF TRUSS.
- ALL TRUSS TO BE 1x1" BOX TRUSS. REFER TO OTHERS FOR ANY RIGGING INFORMATION.

**LEGEND**

ROGUE R1 WASH

ELATION PICASSO

VIDEO WALL

TRIM / CEILING HEIGHT

ARCH. LIGHTING FIXTURE

RIGGIN POINT

DRAWING SCHEDULE		
VER.	DATE	DESCRIPTION
1	10/01/22	DRAFT A - DO NOT BID
2	10/04/22	FOR VENUE REVIEW
3	10/12/22	VERSION B
4	10/16/22	VERSION C - SEATING UPDATE

**UNIQUE STAGING SOLUTIONS**

THIS DRAWING REPRESENTS VISUAL CONCEPTS AND CONSTRUCTION SUGGESTIONS ONLY.

IT DOES NOT REPLACE THE KNOWLEDGE AND ADVICE OF A LICENSED ENGINEER, ELECTRICIAN, OR RIGGER. THE DESIGNER IS UNQUALIFIED TO DETERMINE THE STRUCTURAL OR ELECTRICAL APPROPRIATENESS OF THIS DESIGN, AND WILL NOT ASSUME RESPONSIBILITY FOR INSTALLATION, CONSTRUCTION, HANDLING, OR USE OF EQUIPMENT.

ALL MATERIALS AND CONSTRUCTION MUST COMPLY WITH THE MOST STRINGENT APPLICABLE FEDERAL AND LOCAL FIRE, SAFETY, ENERGY, AND ENVIRONMENTAL CODES.

OMNI  
LOUISVILLE  
HOTEL

LOUISVILLE, KY

**VIDEO LAYOUT**

SCALE: 1/4"=1'-0"

EXCEPT WHERE NOTED

DATE: 10/24/22

DRAWN: CF

2

of 2